

BostonSight PROSE Treatment Assisted Prosthetic Device Application

1. Empty the contents of the case (i.e. the prosthetic device) into the palm of your hand. With the other hand, GENTLY grasp the device by the edges. Note: the device should be wet during this process.

2. Squeeze in on the sides of the plunger before coming into contact with the prosthetic device.

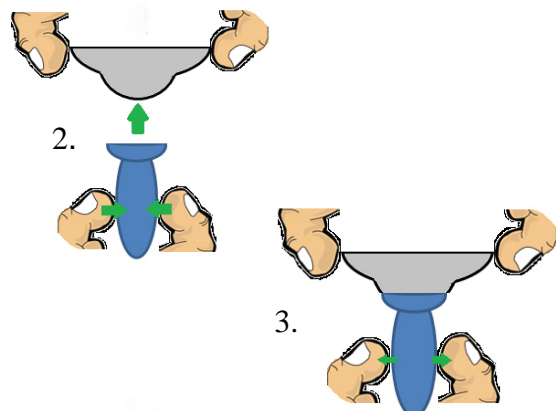

3. Place the face of the plunger over the prosthetic device, and release side pressure on plunger, creating a vacuum between the plunger and the PROSE device.

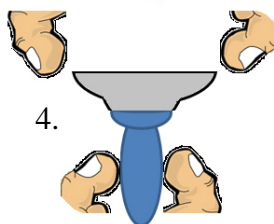

4. Release the sides of the device, holding it with the plunger.

IMPORTANT: Holding the device with the fingers while applying the plunger lessens the force against the device. ALWAYS handle the device by the edges when attempting to attach the plunger to the device. **DO NOT** attach the plunger while the device is resting on a hard surface such as a table or counter top. This will place excessive force on the device, risking breakage. Never squeeze the sides, or place pressure on the face, of the device.

IMPROPER USE OF PLUNGER DURING DEVICE APPLICATION

- DO NOT apply force with plunger in a downward motion causing device to break
- DO NOT use the plunger to contact the device while it is sitting on a hard surface
- DO NOT attempt to take a device out of the case with a plunger

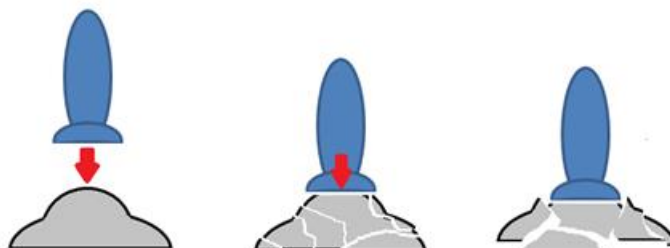

Continued on next page

BostonSight PROSE Treatment Assisted Prosthetic Device Application

5. Place paper towels on the patient's lap to absorb overflow solution.
6. Holding the plunger vertically, overfill device with preservative-free saline, prescribed for the patient. Be careful to let the solution drip, not stream into the device, in order to prevent bubbles from forming.
7. Have the patient sit straight up in a chair with their chin to their chest looking down at the floor, hands, or knee (whichever positions the eye centrally within lid spread). The assistant will hold the upper lid by wrapping their arm by over the patient's head and holding lid from above. This will give the assistant control over head movement. The patient will use one of their hands to hold down the bottom lid for the assistant. The patient and the assistant will work together, holding the eyelids at the edges, where the lashes meet the lids. If the patient is unable to assist, the assistant will hold the lower lid with their pinky and/or ring finger of applying hand while being careful not to tip application plunger. The contact points should be centered on both lids, so as to form a perfectly round opening with plenty of clearance for device application
8. While maintaining proper lid spread, approach the eye smoothly and steadily with device, and have the patient continue to focus on previously determined focus point.
9. Press the device onto the eye with firm pressure.
10. Release the upper lid while instructing the patient to release lower lid to capture the device with the eyelids. Tell patient not to squint. The assistant will maintain the upward pressure on the device while squeezing the plunger in order to release the plunger from the device.
11. The device has now been released onto the eye! Keep the plunger squeezed while retracting it away from the eye.
12. Now check the device in the mirror. Shine a penlight onto the surface of the device and look for the presence of any bubbles in or under the device. If you detect bubbles the device **MUST** be removed and reapplied.
13. Clean the tip of your application plunger with an alcohol prep pad after application of both devices and let it air dry.



BostonSight PROSE Treatment Assisted Prosthetic Device Removal

1. Lubricate the patient's eye thoroughly with preservative-free saline prescribed for them.
2. Wet a removal plunger with the preservative-free saline prescribed for the patient.
3. Have the patient sit upright facing forward looking down slightly.
4. Execute a proper lid spread. Have the patient hold the bottom lid (if able) and the assistant will hold the upper lid wrapping their arm wrapping around the patient's head. It is important to make sure the upper lid is secure during the removal to prevent scratching the patient's eye.
5. While maintaining the lid spread, the assistant creates suction with the plunger at a 45 degree angle. Aim for the 12 o'clock position on the device, at the point where the colored portion of the eye meets the white.
6. The assistant will press the removal plunger firmly, but gently, against the device. The assistant breaks the suction by tipping the bottom of the plunger up and then pulling the plunger in an arc-down-and-out manner, taking care not to scratch your cornea. On some occasions, you may need to pull and relax the plunger rapidly and repeatedly.



NOTE: If the plunger is pressed too close to the center of the device, right over the pupil, it may not be possible to break suction and remove the device. If this occurs, pinch the plunger at the junction of the base and suction cup to release suction.

7. Maintain the lid spread until the device is out of patient's eye.
8. Hold the device gently by the edges and remove the plunger from the device by twisting and maneuvering it towards the edge of the device.
9. Clean tip of removal plunger with alcohol prep pad after removal of both devices and let air dry.